



Recess Punches  
& Fastener Tooling



**REG  
ELLEN  
MACHINE TOOL CORP.**

2135 Kishwaukee St.

Rockford, IL. 61104

(815) 964-0099

Fax: (815) 964-0482

[www.regellen.com](http://www.regellen.com)

# Slotting Saws

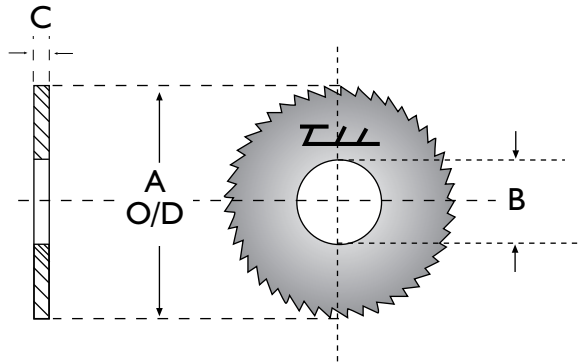

A O/DIA.	B BORE	C THICKNESS IN INCHES	D NUMBER OF TEETH
1 <sup>3</sup> / <sub>4</sub>	5/8	FROM .020 TO .064	56, 64, 72, 90.
2 <sup>3</sup> / <sub>4</sub>	1	FROM .020 TO .110	36, 45, 60, 72.
3	1	FROM .020 TO .110	36, 45, 60, 74.
4	1 <sup>1</sup> / <sub>2</sub>	FROM .040 TO .102	100

Saws used for slotting heads of screws. Available in Imperial and metric sizes. Manufactured from M2 High Speed Steel. Saws are Hollow Ground to give cutting clearance, teeth are ground to give cleaner cut.



Tooling International Ltd. Unit 8, Speedwell Trading Estate,  
102 Kings Road Tyseley, Birmingham, England B11 2AT.

Tel: +44 (0) 121 771 0611 Fax: +44 (0) 121 773 6588  
Web: [www.tooling-international.co.uk](http://www.tooling-international.co.uk) Email: [til@enterprise.net](mailto:til@enterprise.net)

**REG  
ELLEN**  
**MACHINE TOOL CORP.**

**Phone: 815-964-0099**

**Fax: 815-964-0482**

**E-mail: [sales@regellen.com](mailto:sales@regellen.com)**

**Web: [www.regellen.com](http://www.regellen.com)**

