

Recess Punches  
& Fastener Tooling



**REG  
ELLEN  
MACHINE TOOL CORP.**

2135 Kishwaukee St.

Rockford, IL. 61104

(815) 964-0099

Fax: (815) 964-0482

[www.regellen.com](http://www.regellen.com)

# Tri-Wing® Punches

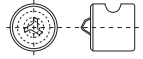

## 100° Flat Head

SCREW SIZE	PUNCH NUMBER	PUNCH BODY DIAMETER
0	TW00-1-1	7/16
2	TW02-1-1	7/16
4	TW04-1-1	7/16
6	TW06-1-1	7/16
8	TW08-1-1	9/16
10	TW10-1-1	9/16
1/4	TW25-1-1	7/8
5/16	TW31-1-1	1
3/8	TW37-1-1	1
7/16	TW43-1-1	1 1/4
1/2	TW50-1-1	1 1/4

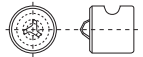

## 100° Flat Head Deep Recess

SCREW SIZE	PUNCH NUMBER	PUNCH BODY DIAMETER
10	TW08-1-135	9/16
5/16	TW25-1-166	1

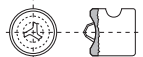

## Pan Head

SCREW SIZE	PUNCH NUMBER	PUNCH BODY DIAMETER
6	TW06-4-1	7/16
8	TW08-4-1	9/16
10	TW10-4-1	9/16
1/4	TW25-4-1	7/8
5/16	TW31-4-1	1
3/8	TW37-4-1	1 1/4

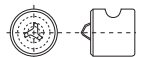

## 100° Flat Head Shear Bolt

SCREW SIZE	PUNCH NUMBER	PUNCH BODY DIAMETER
10	TW08-1-1	9/16
1/4	TW10-1-1	9/16
5/16	TW25-1-1	7/8
3/8	TW31-1-1	1

Gauges to suit available



# Tri-Wing® Punches

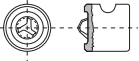

## Modified Pan Head

SCREW SIZE	PUNCH NUMBER	PUNCH BODY DIAMETER
0	TW00-11-1	7/16
2	TW02-11-1	7/16
4	TW04-11-1	7/16
6	TW06-11-1	7/16
8	TW08-11-1	9/16
10	TW10-11-1	9/16
1/4	TW25-11-1	7/8
5/16	TW31-11-1	1
3/8	TW37-11-1	1 1/4

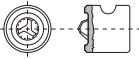

## Modified Pan Head Deep Recess

SCREW SIZE	PUNCH NUMBER	PUNCH BODY DIAMETER
10	TW08-11-2	9/16
5/16	TW25-12-94	1

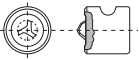

## Washer Face Trimmed Hexagon Head

SCREW SIZE	PUNCH NUMBER	PUNCH BODY DIAMETER
4	TW04-10-1	7/16
6	TW06-10-1	7/16
8	TW08-10-1	9/16
10	TW10-10-1	9/16

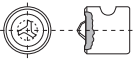

## Washer Face Trimmed Hexagon Deep Recess

SCREW SIZE	PUNCH NUMBER	PUNCH BODY DIAMETER
10	TW08-10-35	9/16

Gauges to suit available

# Tri-Wing® Punches



## 100° Oval Head



SCREW SIZE	PUNCH NUMBER	PUNCH BODY DIAMETER
4	TW04-3-1	7/16
6	TW06-3-1	7/16
8	TW08-3-1	9/16
10	TW10-3-1	9/16
1/4	TW25-3-1	7/8
5/16	TW31-3-1	1
3/8	TW37-3-1	1 1/4

## 100° Oval Head Deep Recess

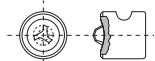

SCREW SIZE	PUNCH NUMBER	PUNCH BODY DIAMETER
10	TW08-3-1	9/16
5/16	TW25-3-1	1

## Washer Face Indented Hexagon Head

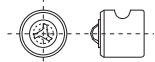

SCREW SIZE	PUNCH NUMBER	PUNCH BODY DIAMETER
4	TW04-9-1	7/16
6	TW06-9-1	7/16
8	TW08-9-1	9/16
10	TW10-9-1	9/16

## Washer Head Double Radius



SCREW SIZE	PUNCH NUMBER	PUNCH BODY DIAMETER
4	TW04-7-1	7/16
6	TW06-7-1	7/16
8	TW08-7-1	9/16
10	TW10-7-1	9/16
1/4	TW25-7-1	7/8
5/16	TW31-7-1	1
3/8	TW37-7-1	1 1/4

Gauges to suit available



# ACR® Tri-Wing® Punches

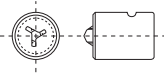

## 100° Tension and Fillister Head and 100° Reduced Head

SCREW SIZE		PUNCH NUMBER	PUNCH BODY DIAMETER
100° TENSION & FILLISTER HEADS	100° REDUCED HEAD		
.060	-	PSC-3101-0	7/16
.086	-	PSC-3101-1	7/16
.112	-	PSC-3101-2	7/16
.138	-	PSC-3101-4	7/16
.164	.190	PSC-3101-4J	9/16
.190	.250	PSC-3101-5	9/16
.250	.312	PSC-3101-6	7/8
.312	.375	PSC-3101-7	1
.375	.438	PSC-3101-8	1
.438	.500	PSC-3101-9	1 1/4
.500	.562	PSC-3101-10	1 1/4

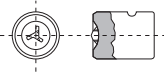

## 100° Oval Head

SCREW SIZE	PUNCH NUMBER	PUNCH BODY DIAMETER
.060	PSC-3104-0	7/16
.086	PSC-3104-1	7/16
.112	PSC-3104-2	7/16
.138	PSC-3104-3	9/16
.164	PSC-3104-4	9/16
.190	PSC-3104-4J	9/16
.190	PSC-3104-5	9/16
.250	PSC-3104-6	7/8
.312	PSC-3104-7	1
.375	PSC-3104-8	1

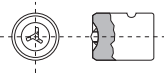

## Trimmed Hexagon Head

SCREW SIZE	PUNCH NUMBER	PUNCH BODY DIAMETER
.112	PSC-3105-2	7/16
.138	PSC-3105-3	7/16
.164	PSC-3105-4	9/16
.190	PSC-3105-4J	9/16
.190	PSC-3105-5	9/16

Gauges to suit available

# ACR® Tri-Wing® Punches



## Flat Pan Head

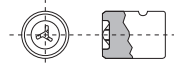

SCREW SIZE	PUNCH NUMBER	PUNCH BODY DIAMETER
.060	PSC-3106-0	7/16
.086	PSC-3106-1	7/16
.112	PSC-3106-2	7/16
.138	PSC-3106-3	7/16
.164	PSC-3106-4	9/16
.190	PSC-3106-4J	7/8
.190	PSC-3106-5	7/8
.250	PSC-3106-6	7/8
.312	PSC-3106-7	1
.375	PSC-3106-8	1 1/4

## Mush Head

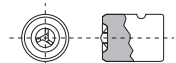

SCREW SIZE	PUNCH NUMBER	PUNCH BODY DIAMETER
M4	PSC-3108-4	9/16
M5	PSC-3108-5	7/8
M6	PSC-3108-6	1
M8	PSC-3108-7	1

## 100° Reduced Crown

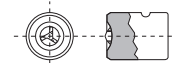

SCREW SIZE	PUNCH NUMBER	PUNCH BODY DIAMETER
M5	PSC-3123-4	9/16
M6	PSC-3123-5	9/16
M8	PSC-3123-6	7/8
M10	PSC-3123-7	7/8
M12	PSC-3123-8	1

Gauges to suit available



Tooling International Ltd. Unit 8, Speedwell Trading Estate,  
102 Kings Road Tyseley, Birmingham, England B11 2AT.

Tel: +44 (0) 121 771 0611 Fax: +44 (0) 121 773 6588  
Web: [www.tooling-international.co.uk](http://www.tooling-international.co.uk) Email: [til@enterprise.net](mailto:til@enterprise.net)

**REG  
ELLEN**  
**MACHINE TOOL CORP.**

**Phone: 815-964-0099**

**Fax: 815-964-0482**

**E-mail: [sales@regellen.com](mailto:sales@regellen.com)**

**Web: [www.regellen.com](http://www.regellen.com)**

